



2 ELDEN STREET



1 MONROE STREET



4 NACHMAN WAY



3 MIXED USE BUILDING



604 MONTGOMERY STREET
ALEXANDRIA, VIRGINIA 22314
(703) 549-7766 PH • (703) 684-6212 FAX

© HEFFNER ARCHITECTS, PC.
This drawing and the design of all components shown are the sole property
of HEFFNER ARCHITECTS, PC. and are intended for this project specifically.
The reproduction, copying or use of this drawing or any of its components is
strictly prohibited without the written consent of HEFFNER ARCHITECTS, PC.
Any infringement of this copyright will be subject to strict legal action.

JUNCTION SQUARE

2015-05-15



P100



2 ELEVATION - MONROE STREET (EAST)
1/8" = 1'-0"



1 ELEVATION - ELDEN STREET (SOUTH)
1/8" = 1'-0"

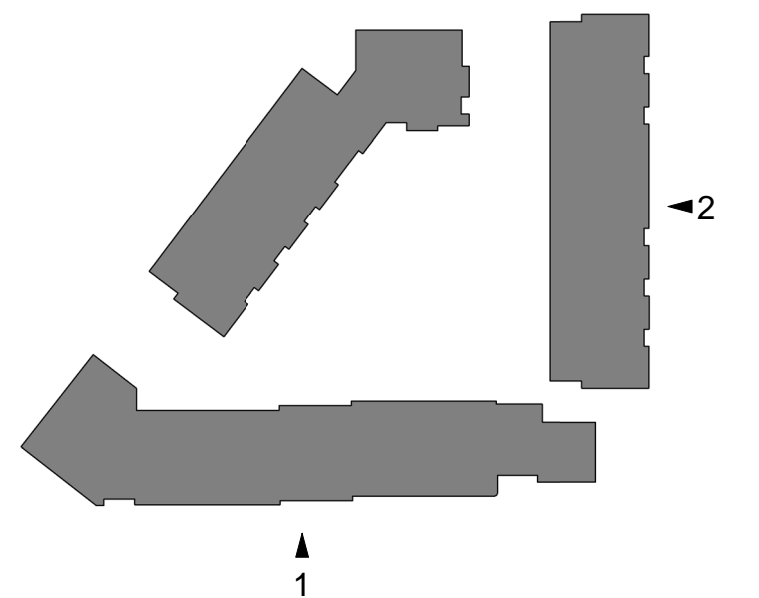

ELEVATION KEY



604 MONTGOMERY STREET
ALEXANDRIA, VIRGINIA 22314
(703) 549-7766 PH • (703) 684-6212 FAX

© HEFFNER ARCHITECTS, PC.
This drawing and the design of all components shown are the sole property
of HEFFNER ARCHITECTS, PC. and are intended for this project specifically.
The reproduction, copying or use of this drawing or any of its components is
strictly prohibited without the written consent of HEFFNER ARCHITECTS, PC.
Any infringement of this copyright will be subject to strict legal action.

JUNCTION SQUARE

2015-05-15



P101



2 ELEVATION - NACHMAN WAY (WEST)
1/8" = 1'-0"



1 ELEVATION - NACHMAN WAY (NORTH)
1/8" = 1'-0"



604 MONTGOMERY STREET
ALEXANDRIA, VIRGINIA 22314
(703) 549-7766 PH • (703) 684-6212 FAX

© HEFFNER ARCHITECTS, PC.
This drawing and the design of all components shown are the sole property
of HEFFNER ARCHITECTS, PC and are intended for this project specifically.
The reproduction, copying or use of this drawing or any of its components is
strictly prohibited without the written consent of HEFFNER ARCHITECTS, PC.
Any infringement of this copyright will be subject to strict legal action.

JUNCTION SQUARE

2015-05-15



P102



1 ELEVATION - DYER COURT (WEST)
1/8" = 1'-0"



3 ELEVATION - DYER COURT (SOUTHEAST)
1/8" = 1'-0"



2 ELEVATION - DYER COURT (SOUTH)
1/8" = 1'-0"

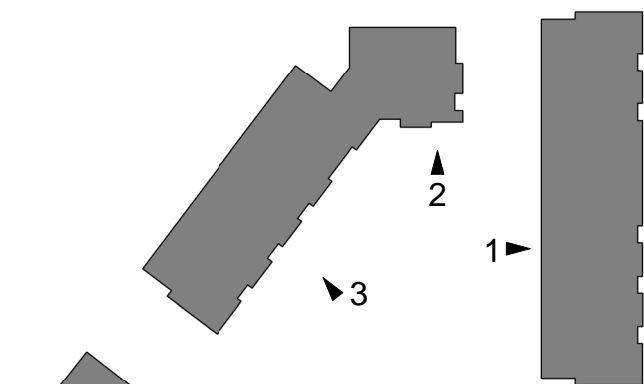

ELEVATION KEY



JUNCTION SQUARE

2015-05-15

P103

604 MONTGOMERY STREET
ALEXANDRIA, VIRGINIA 22314
(703) 549-7766 PH • (703) 684-6212 FAX

© HEFFNER ARCHITECTS, PC.
This drawing and the design of all components shown are the sole property
of HEFFNER ARCHITECTS, PC and are intended for this project specifically.
The reproduction, copying or use of this drawing or any of its components is
strictly prohibited without the written consent of HEFFNER ARCHITECTS, PC.
Any infringement of this copyright will be subject to strict legal action.



1 ELEVATION - DYER COURT (NORTH)
1/8" = 1'-0"



2 ALLEY - WEST ELEVATION
1/8" = 1'-0"



604 MONTGOMERY STREET
ALEXANDRIA, VIRGINIA 22314
(703) 549-7766 PH • (703) 684-6212 FAX

© HEFFNER ARCHITECTS, PC.
This drawing and the design of all components shown are the sole property
of HEFFNER ARCHITECTS, PC and are intended for this project specifically.
The reproduction, copying or use of this drawing or any of its components is
strictly prohibited without the written consent of HEFFNER ARCHITECTS, PC.
Any infringement of this copyright will be subject to strict legal action.

JUNCTION SQUARE

2015-05-15

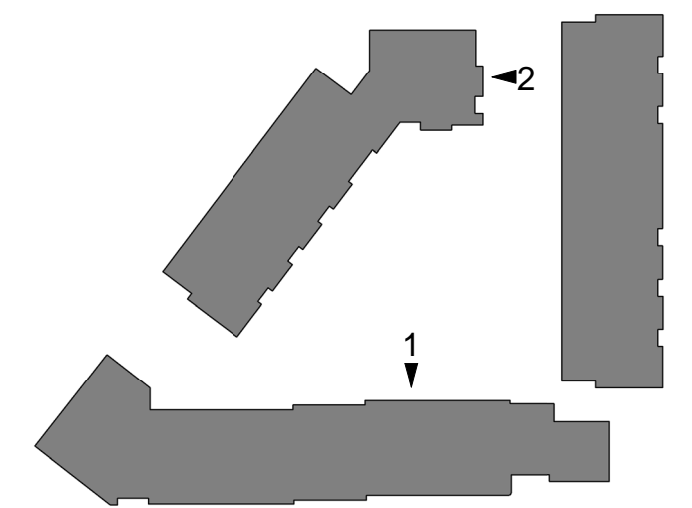

ELEVATION KEY



P104